



Neviso 5x3 44

GYT

1

SHEET

7

OF

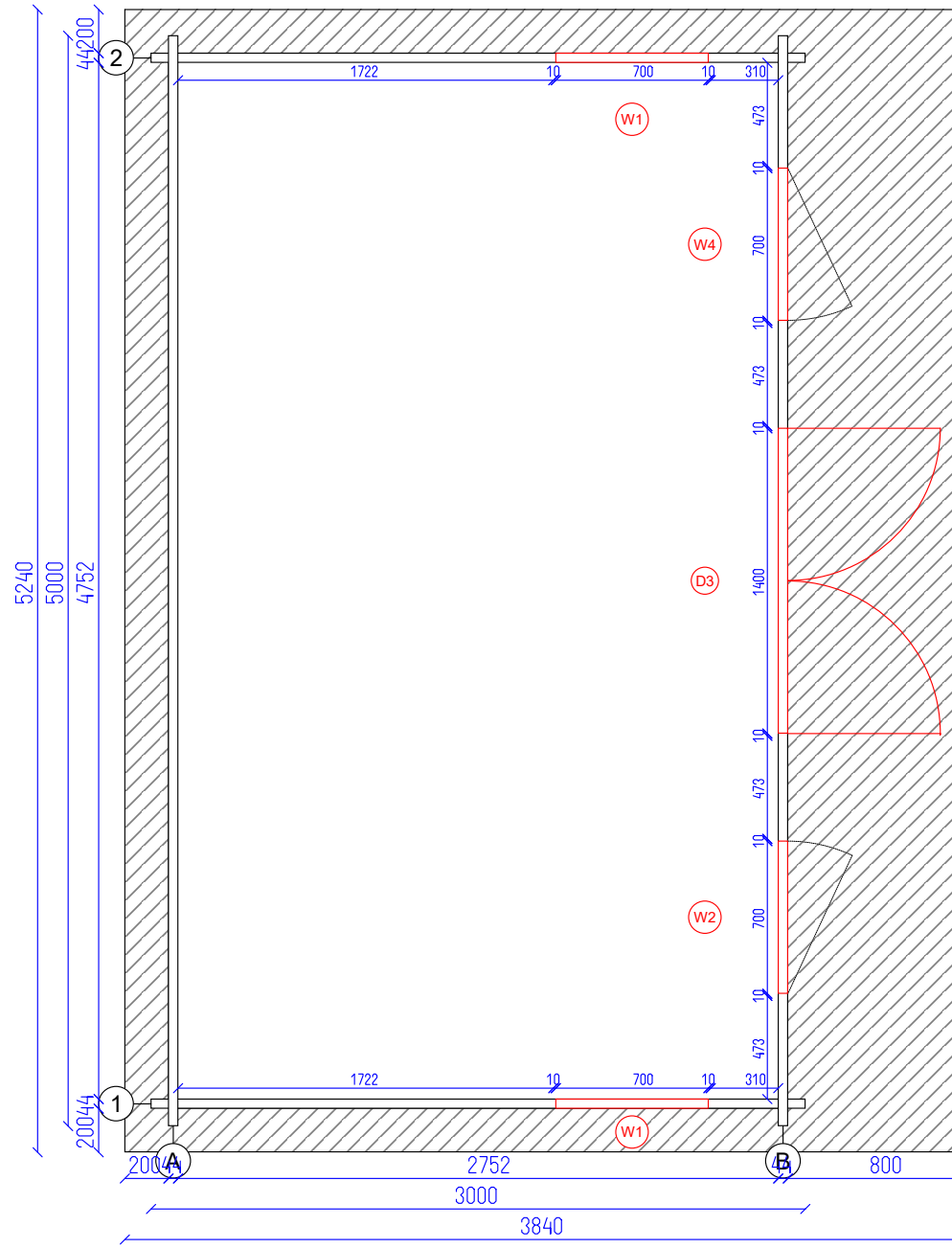

Neviso 5x3 44

Ground plan

GYT

2

SHEET

7

OF

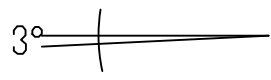

3844

2755

2368

2160

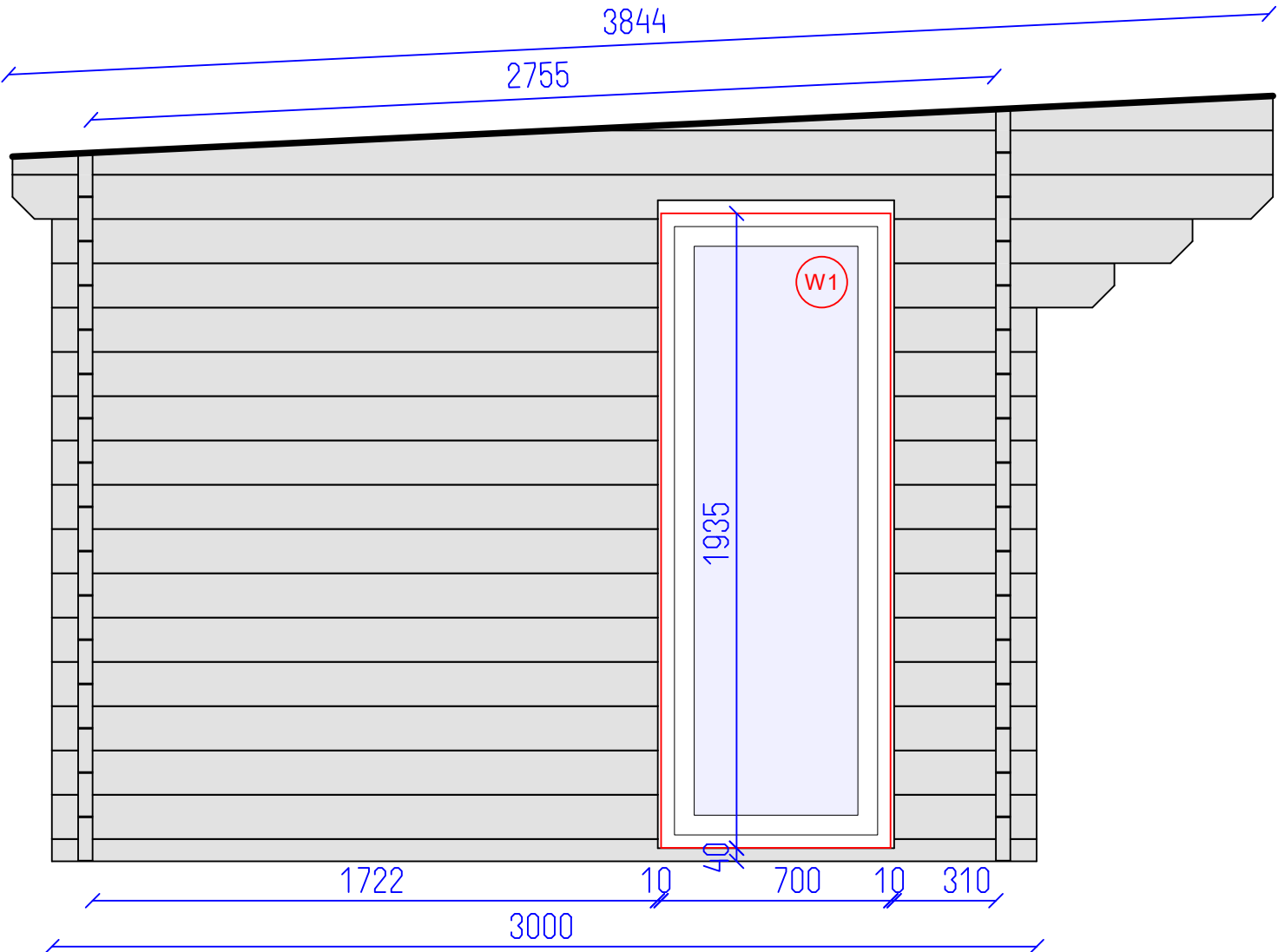

1722

10

40

700

10

310

3000

1935

W1

A

B

DETAILS

| N | QTY |
|---|-----|
| 1 | 1 |
| 2 | 14 |
| 3 | 12 |
| 4 | 1 |
| 5 | 1 |
| 6 | 1 |
| 7 | 1 |
| 8 | 1 |

LIST OF ELEMENTS

- 1. Wall 68x44x3000
 - 2. Wall 135x44x1846
 - 3. Wall 135x44x434
 - 4. Wall 135x44x671
 - 5. Wall 135x44x909
 - 6. Wall 135x44x3840
 - 7. Wall 135x44x3840
 - 8. Wall 105x44x2179
- Total 5.87 m²

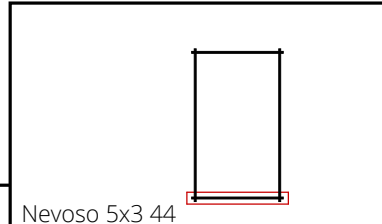

Nevoso 5x3 44



DETAILS

| N | QTY |
|----|-----|
| 9 | 15 |
| 10 | 1 |
| 18 | 4 |

LIST OF ELEMENTS

9. Wall 135x44x5000
 10. Wall 135x44x5000
 18. Roof beam 140x70x3850
 Total 12.96 m²

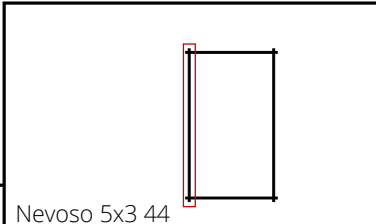
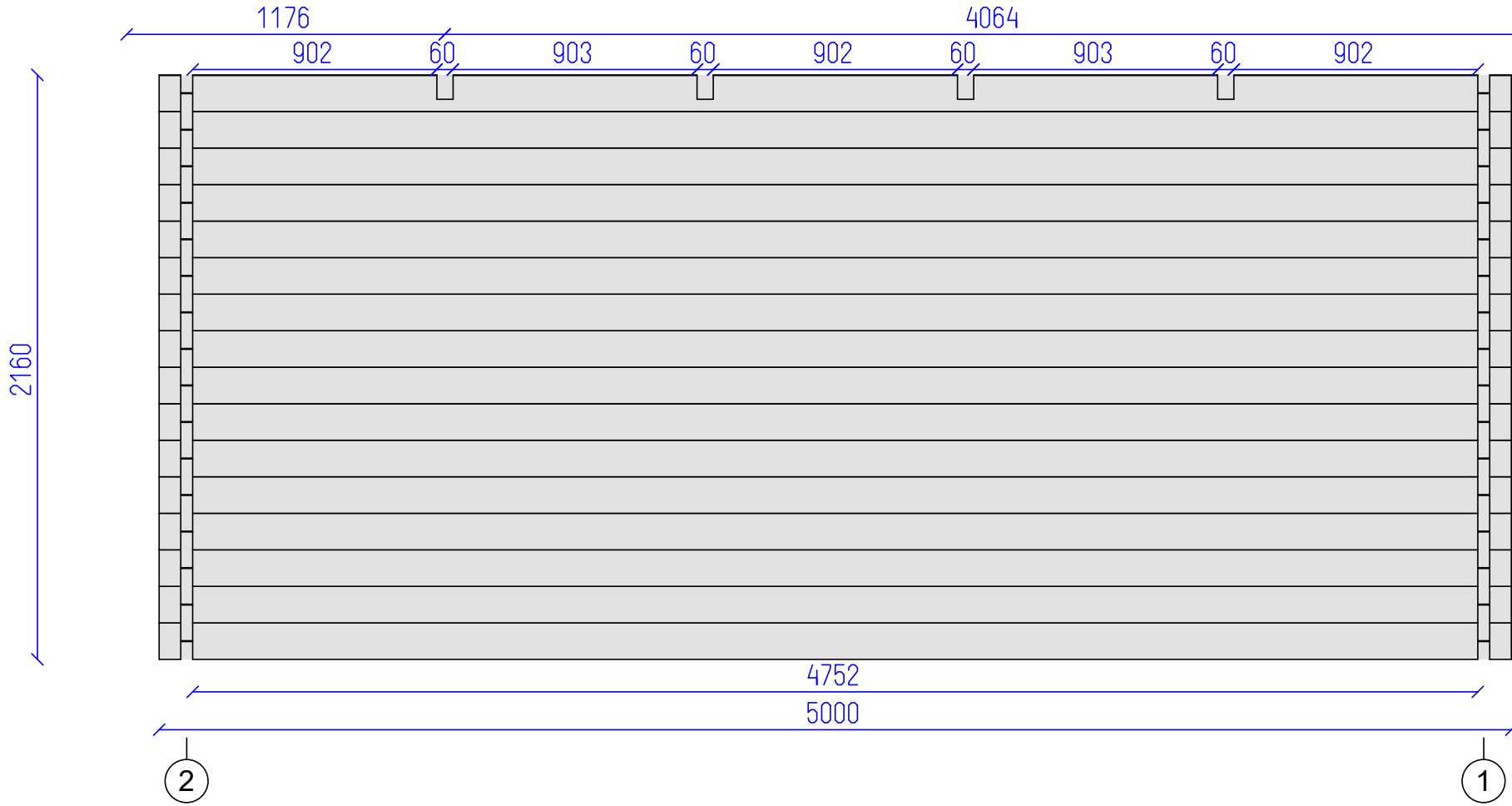

Neviso 5x3 44



Wall A

GYT

4

7

SHEET

OF

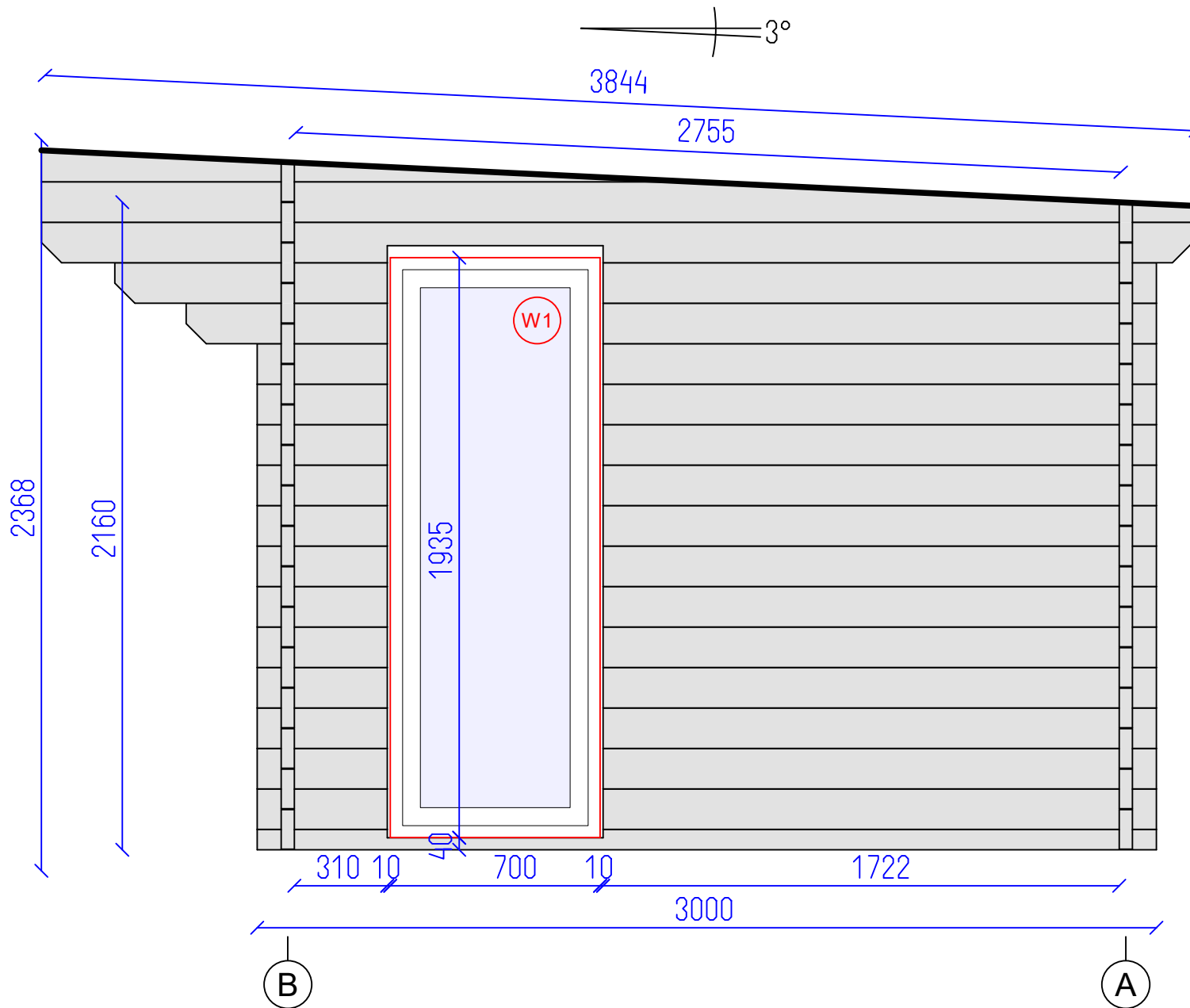

DETAILS

| N | QTY |
|---|-----|
| 1 | 1 |
| 2 | 14 |
| 3 | 12 |
| 4 | 1 |
| 5 | 1 |
| 6 | 1 |
| 7 | 1 |
| 8 | 1 |

LIST OF ELEMENTS

- 1. Wall 68x44x3000
 - 2. Wall 135x44x1846
 - 3. Wall 135x44x434
 - 4. Wall 135x44x671
 - 5. Wall 135x44x909
 - 6. Wall 135x44x3840
 - 7. Wall 135x44x3840
 - 8. Wall 105x44x2179
- Total 5.87 m²

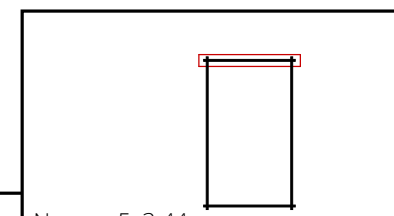

Neviso 5x3 44



DETAILS

| N | QTY |
|----|-----|
| 11 | 1 |
| 12 | 1 |
| 13 | 13 |
| 14 | 26 |
| 15 | 13 |
| 16 | 1 |
| 9 | 1 |
| 17 | 1 |
| 18 | 4 |

LIST OF ELEMENTS

- 11. Wall 135x44x1790
 - 12. Wall 135x44x1790
 - 13. Wall 135x44x597
 - 14. Wall 135x44x473
 - 15. Wall 135x44x597
 - 16. Wall 135x44x5000
 - 9. Wall 135x44x5000
 - 17. Wall 134x44x5000
 - 18. Roof beam 140x70x3850
- Total 8.42 m²

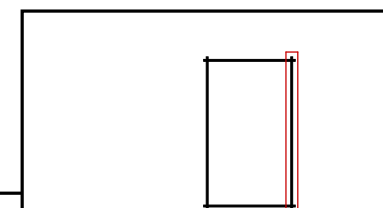
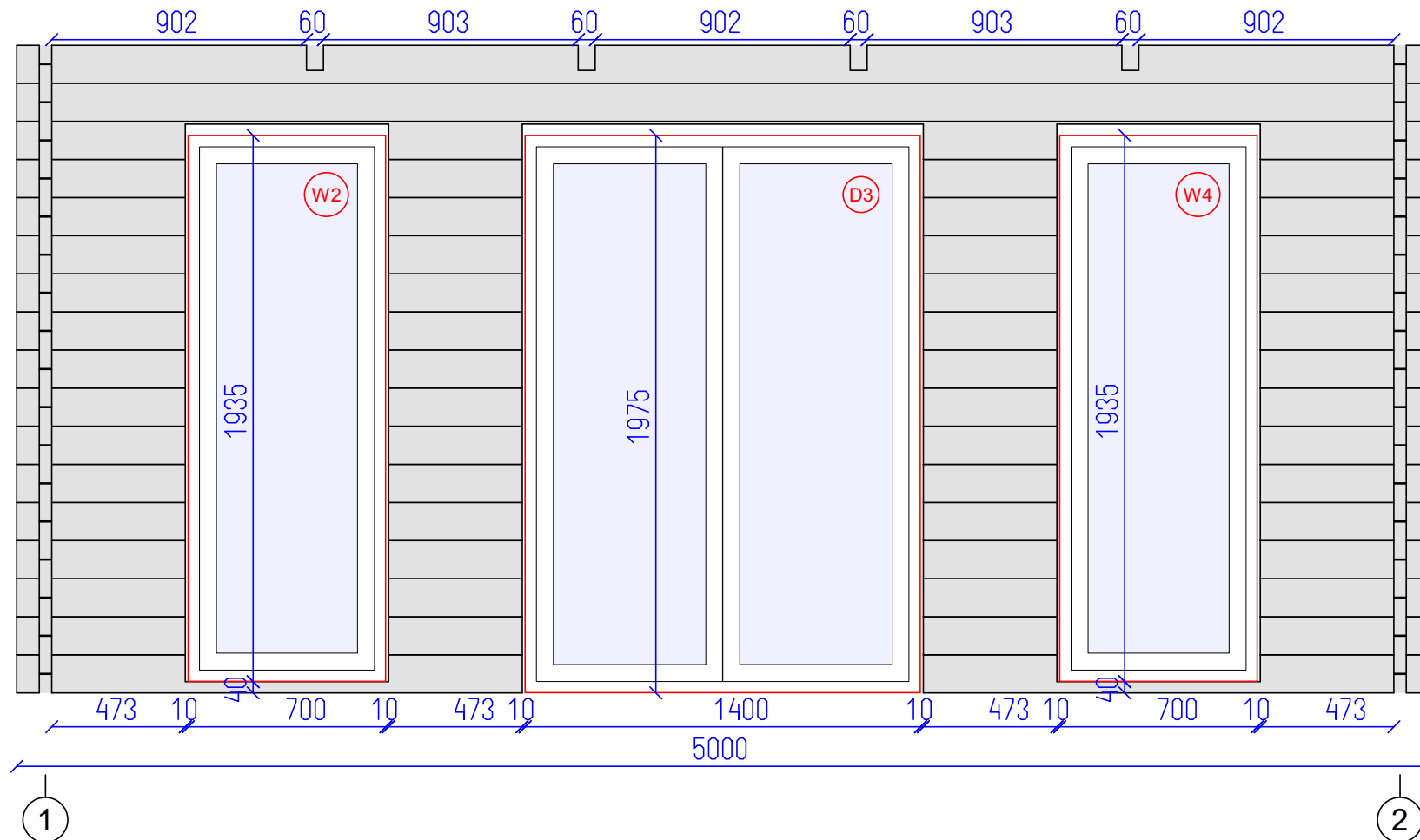

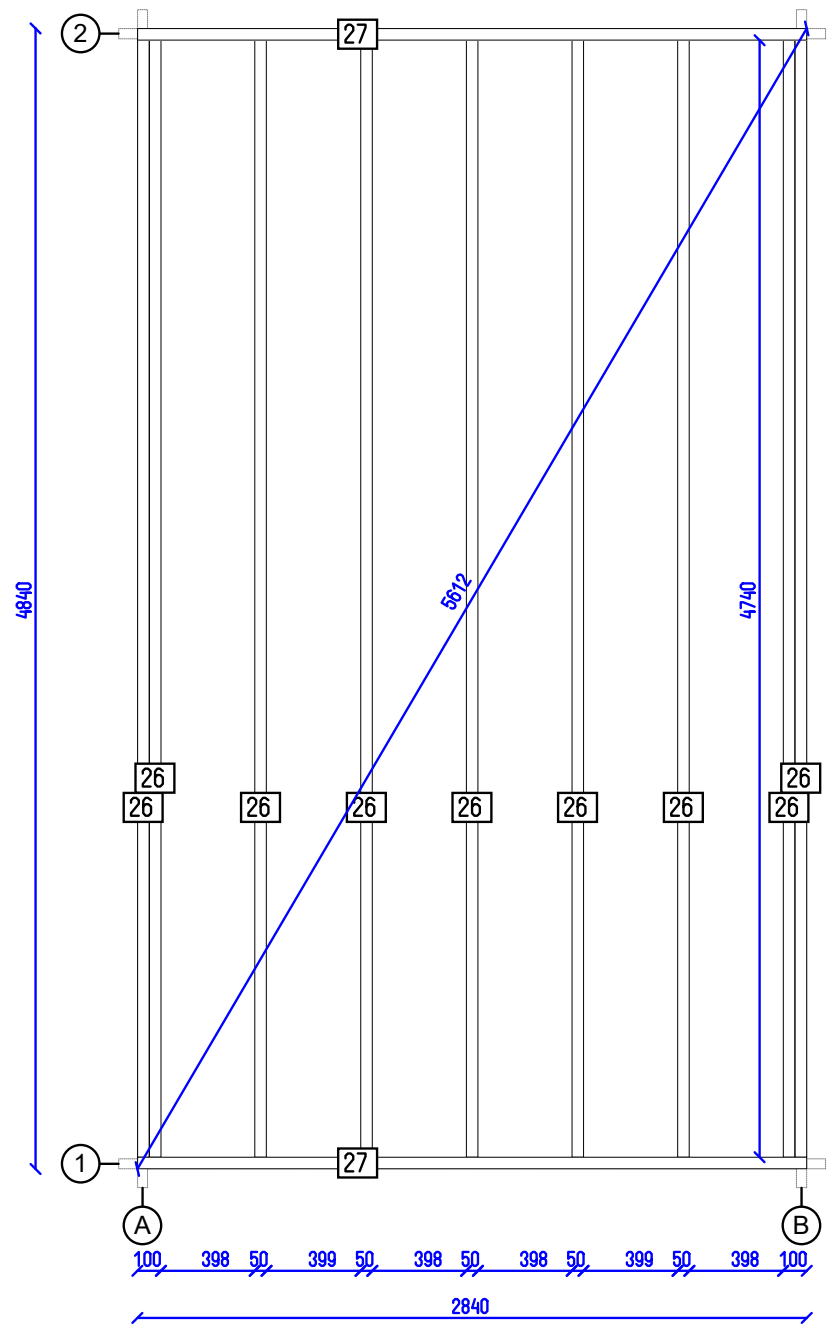

Nevosos 5x3 44

Base plan

GYT

7

SHEET

7

OF