

**A parts list of the position**



<b>Alpina plus 5x4 LTH (44)</b>				
Position	Name	L Length mm	Q	M2
003.	Foundation treated bearer	3056	1	
003.a	Foundation treated bearer	3813	1	
003.b	Foundation treated bearer	4719	9	
003.c	Foundation treated bearer	3043	4	
003.d	Foundation treated bearer	1770	4	
003.e	Foundation treated bearer	757	1	
007.	Terrace floor board	800		1,54
008.	Floor board	2960		19,09
008.a	Floor board	3717		
009.	trims for flooring	2384	2	
009.a	trims for flooring	1499	2	
009.b	trims for flooring	1505	2	
009.c	trims for flooring	1884	2	
009.d	trims for flooring	754	2	
009.e	trims for flooring	1767	2	
010.	Strip (for inside roof)	36200	1	
017.	Various wall log 44x135	324068	1	
037.	Roof board	2120		23,41
039.	Fascia board	2140	4	
039.a	Fascia board strip	2150	4	
039.b	Roof strip	2685	4	
043.	Strip	1860	1	
044.	Double outside door 1295x1860mm	-	1	
045.	Double window 1380x910 mm	-	2	
046.	Double door strip (horizontal)	1395	2	
046.a	Double door strip (vertical)	1830	4	
046.b	Double window strip (horizontal)	1480	8	
046.c	Double window strip (vertical)	880	8	
058.	Rhombus	135	4	
060.	Screw for walls 6x180	-	123	
060.a	Screw set	-	1	
070.	Door/window hardware	-	1	
070.a	Door/window hardware	-	1	
070.b	Door/window hardware	-	1	
070.c	Screw	-	16	
070.d	Door/window hardware	-	8	

I. Architectural drawings



**Alpina plus 5x4 LTH (44)**

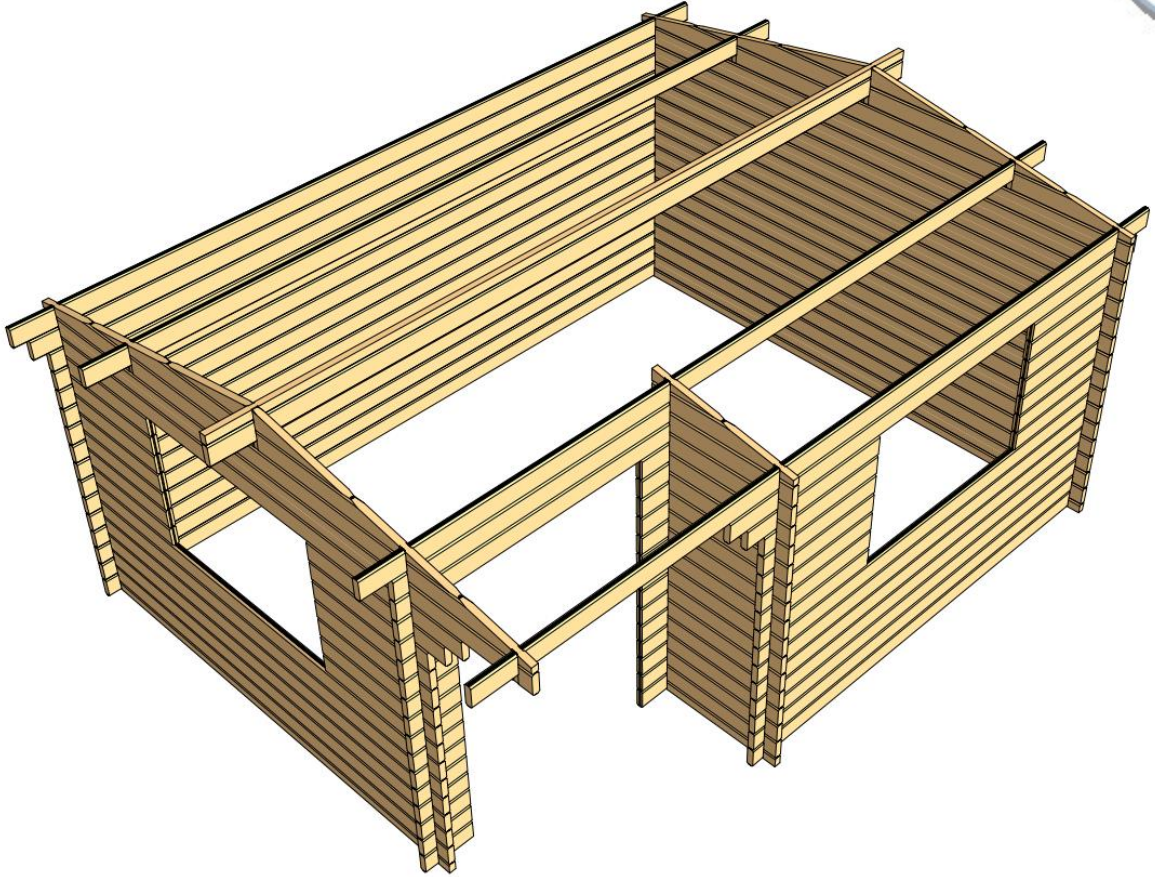

I.1. Foundation plan dimensions:

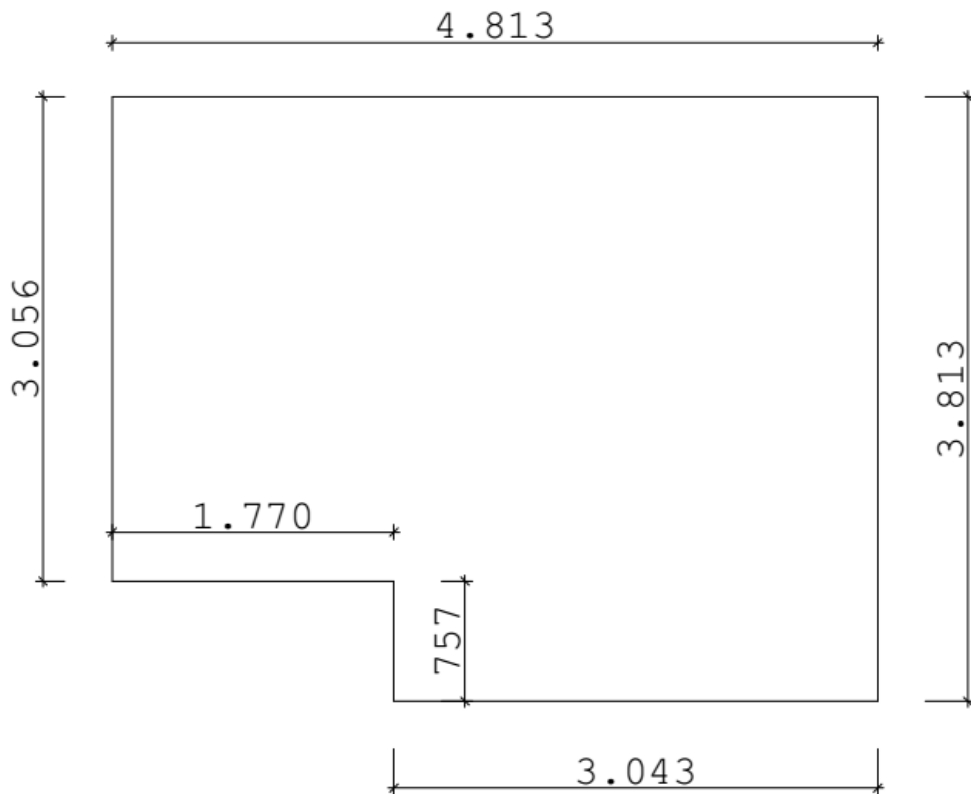

I.2. Building plan:

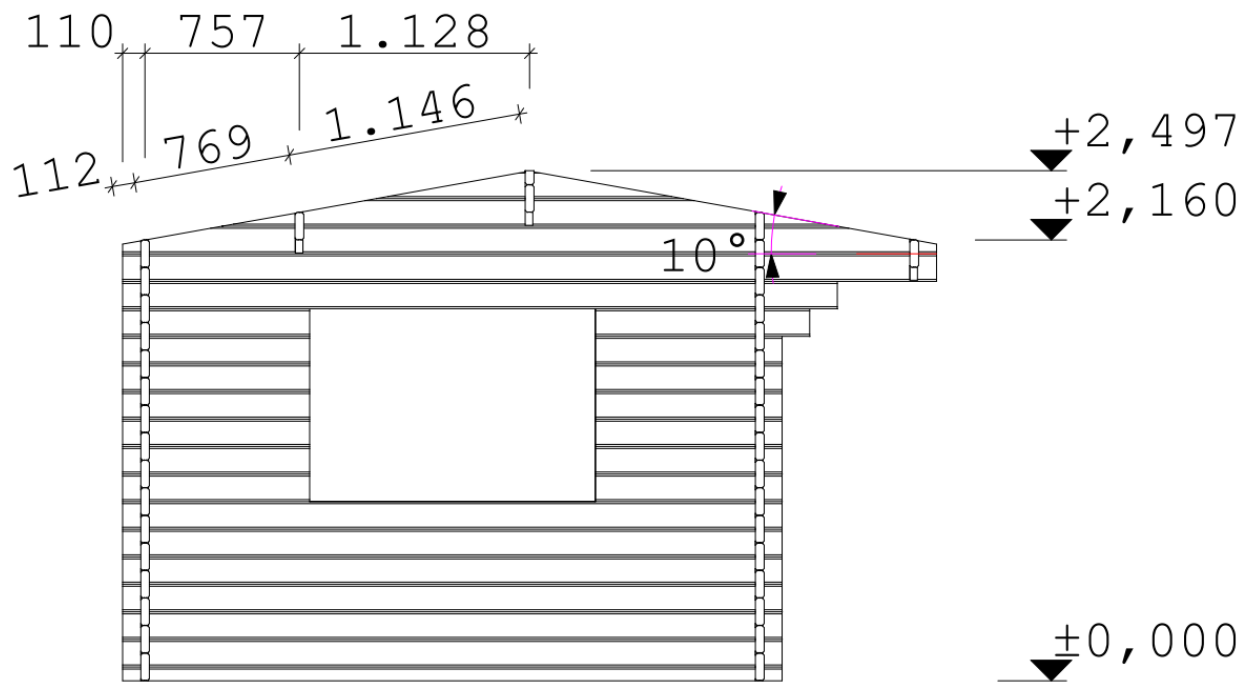
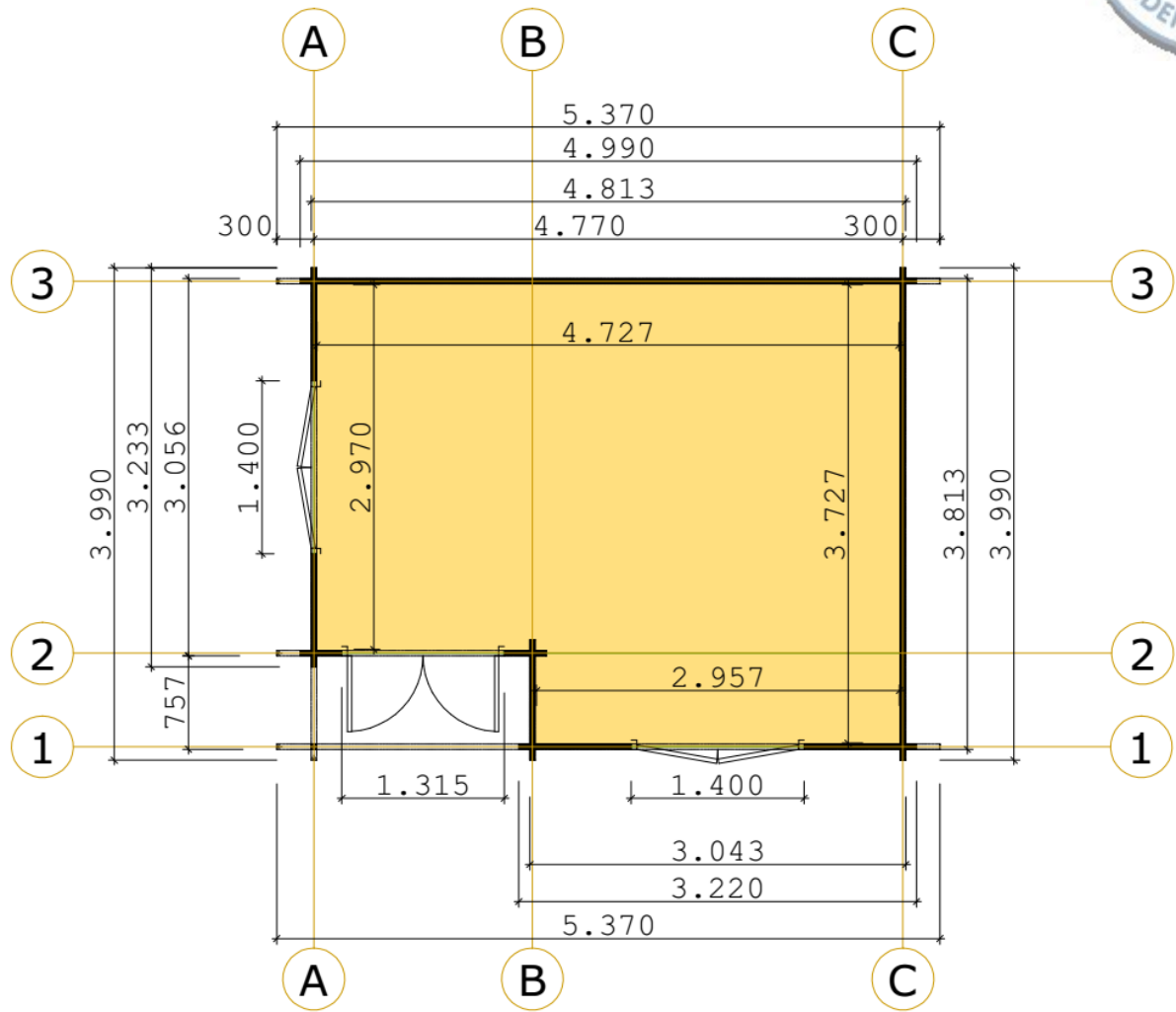

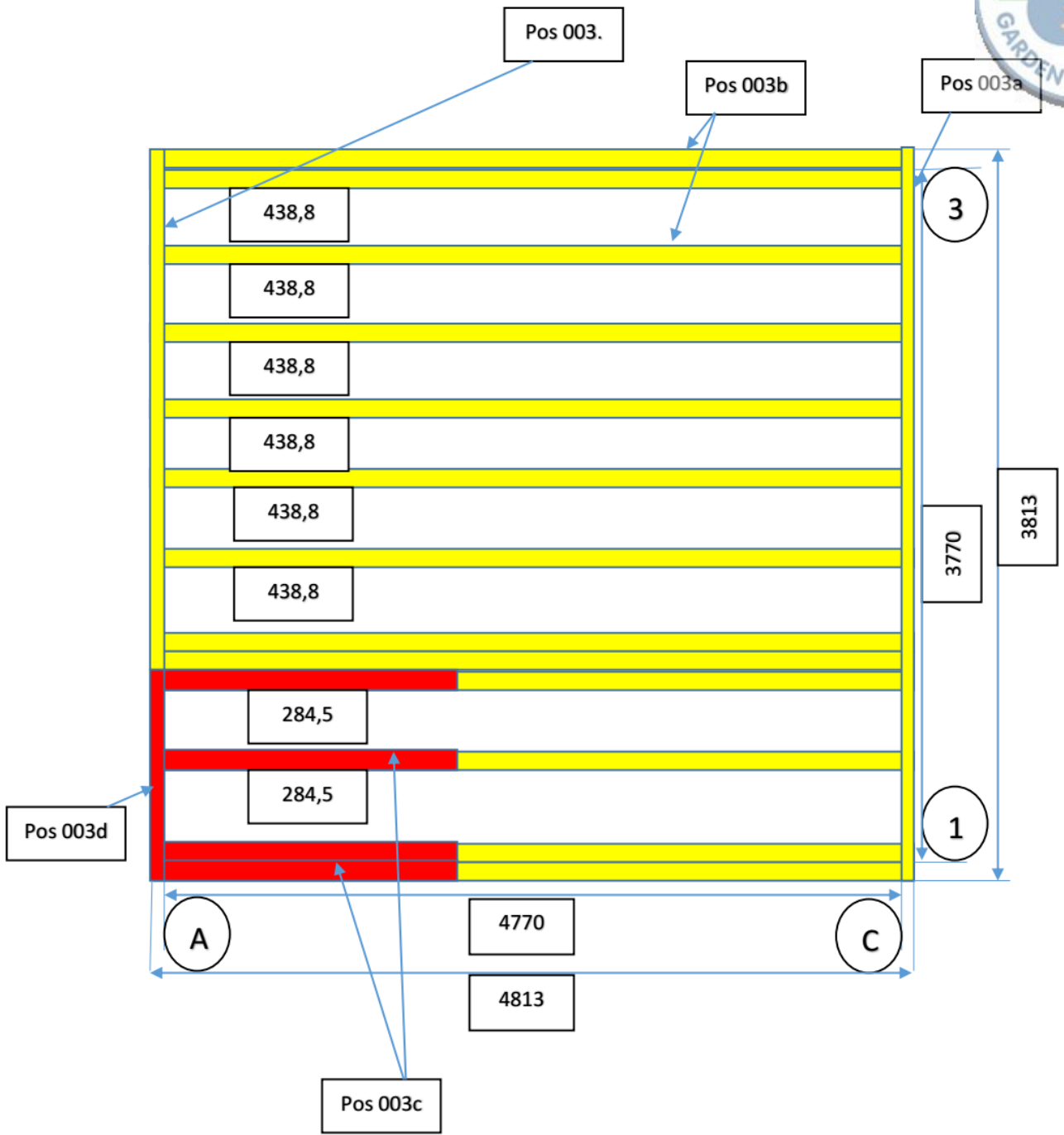

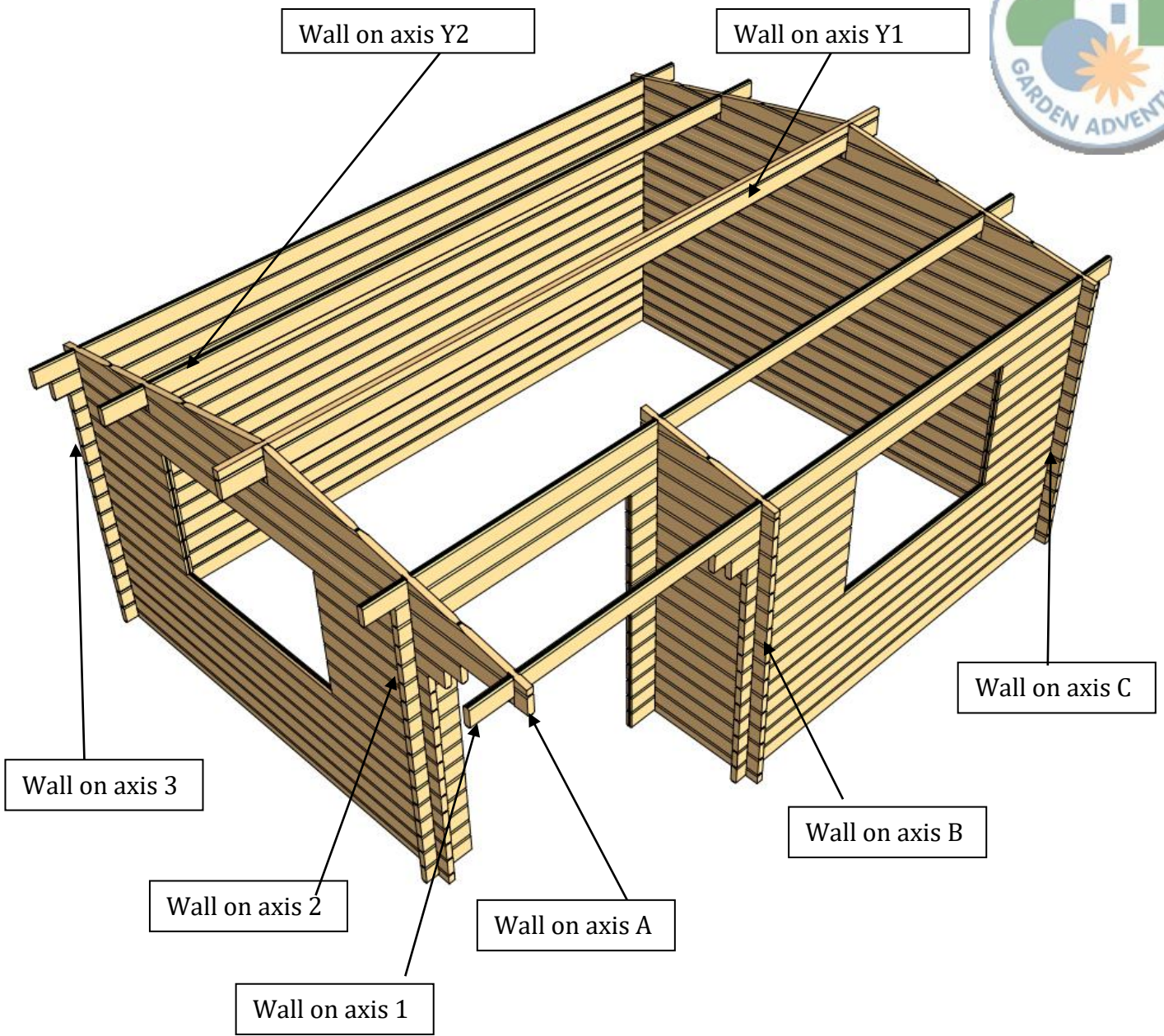

We recommend 19 screw to this wall.

## Wall on axis 1

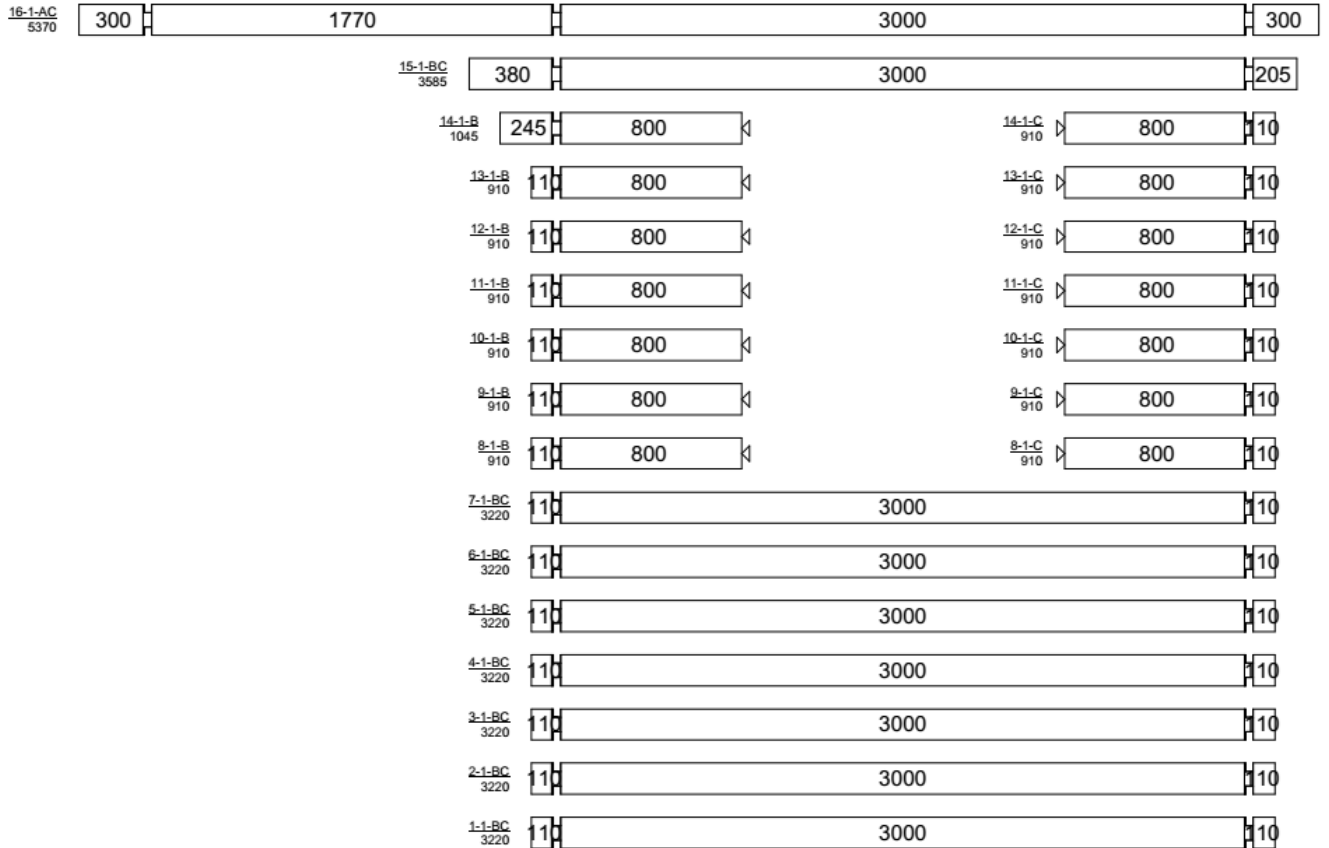

↑

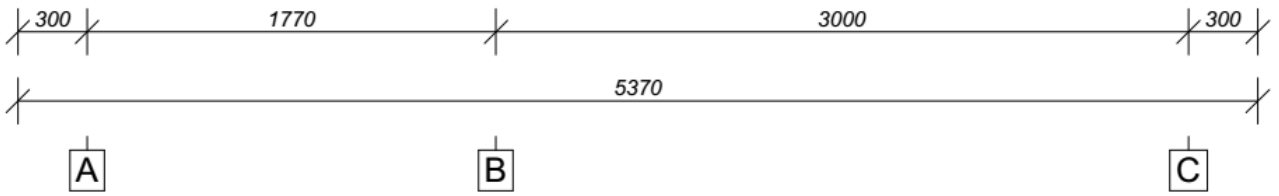



We recommend 19 screws to this wall.

## Wall on axis 2

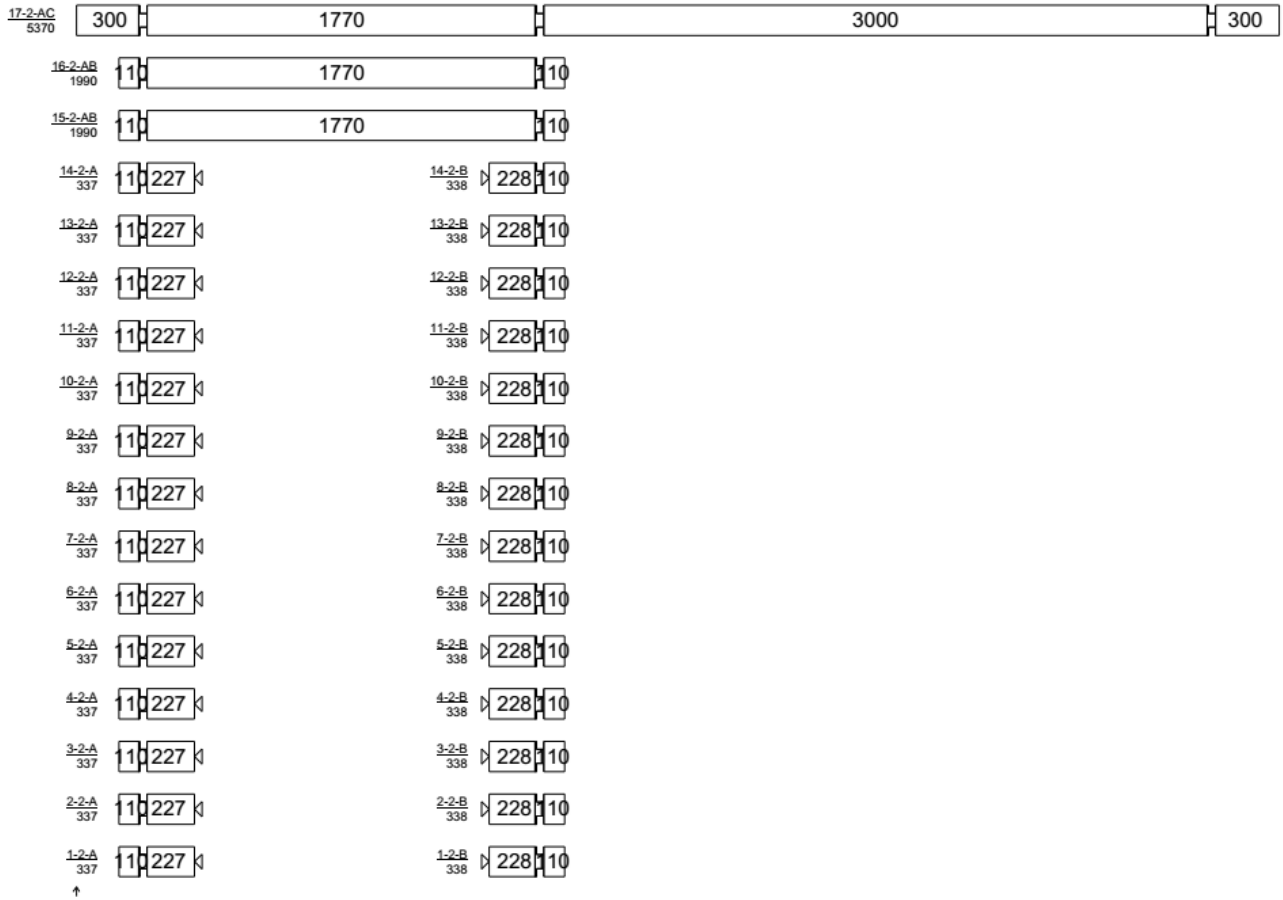



We recommend 23 screws to this wall.

### Wall on axis 3

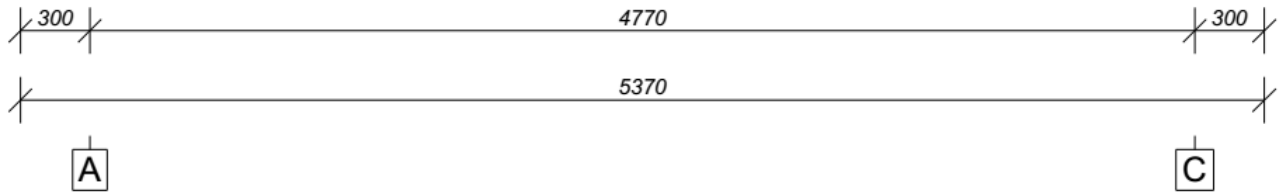
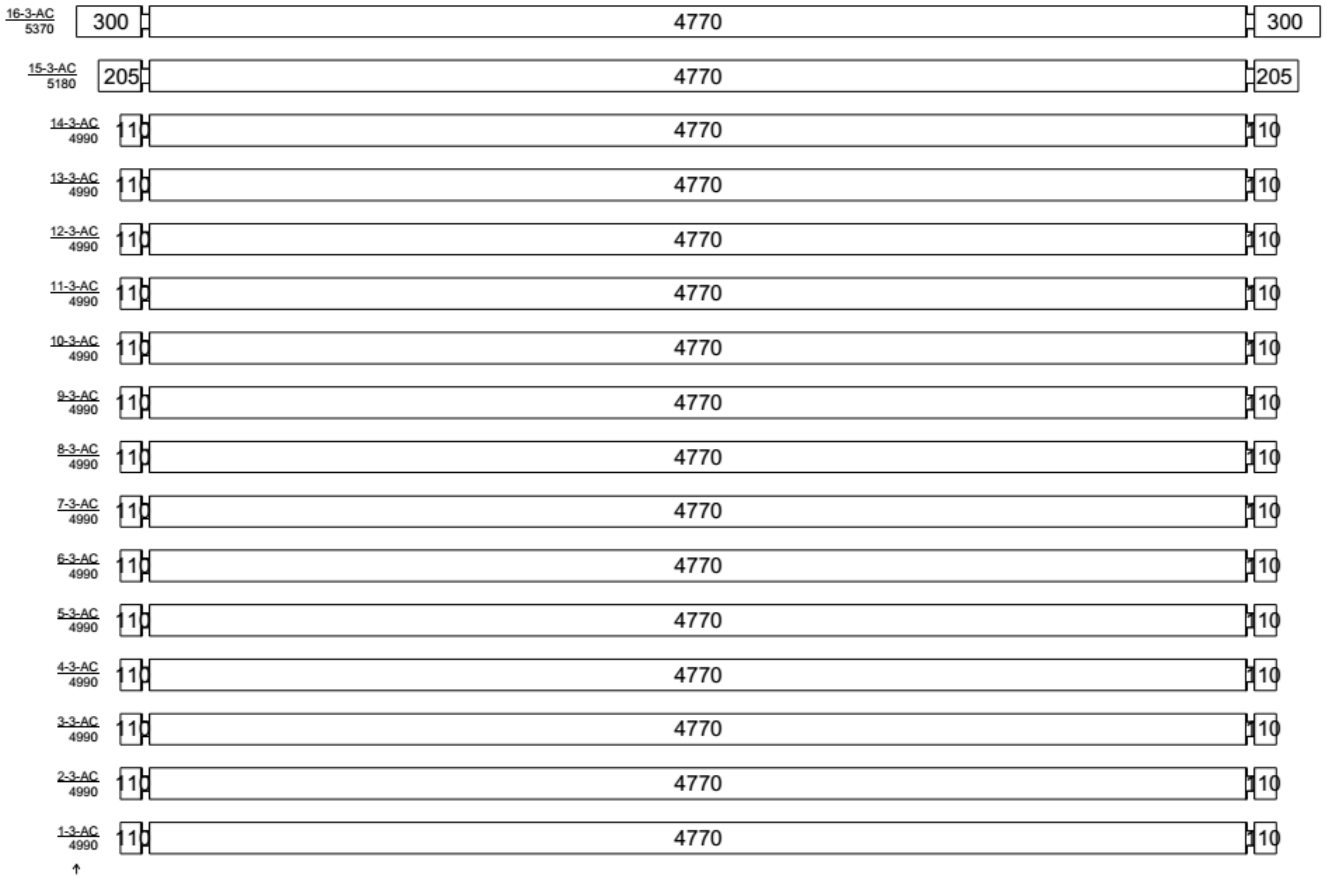



We recommend  
24 screw to this  
wall.



## Wall on axis A

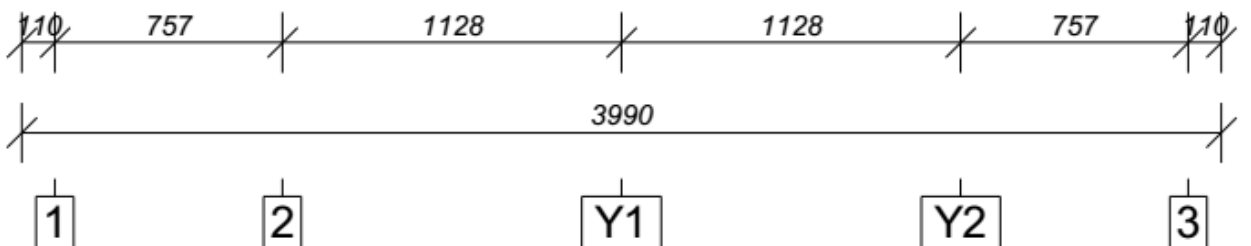
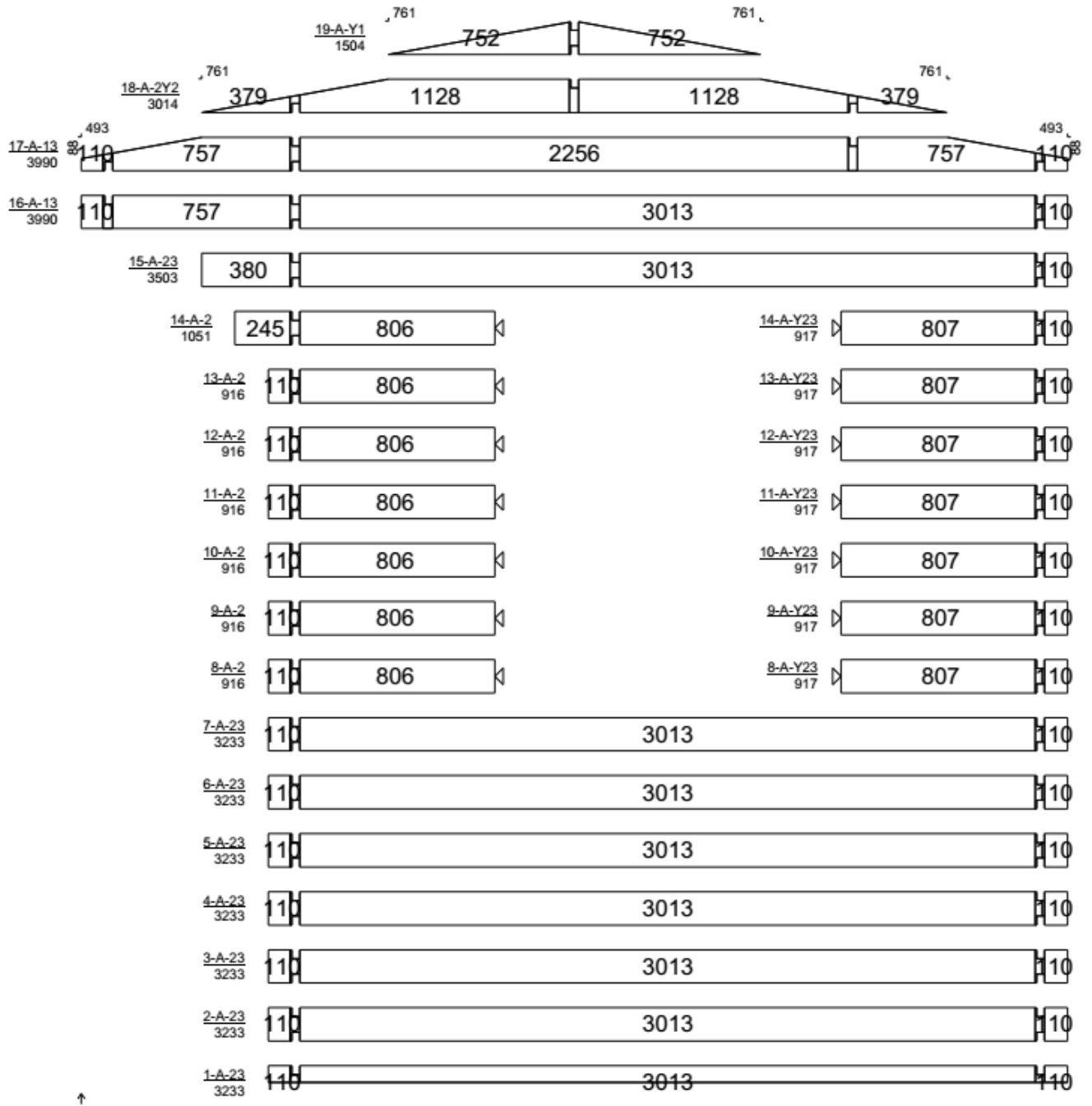



We recommend 9 screw to this wall.

## Wall on axis B

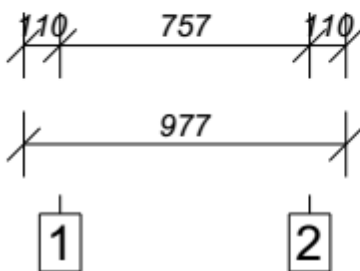

We recommend  
27 screw to this  
wall.



## Wall on axis C

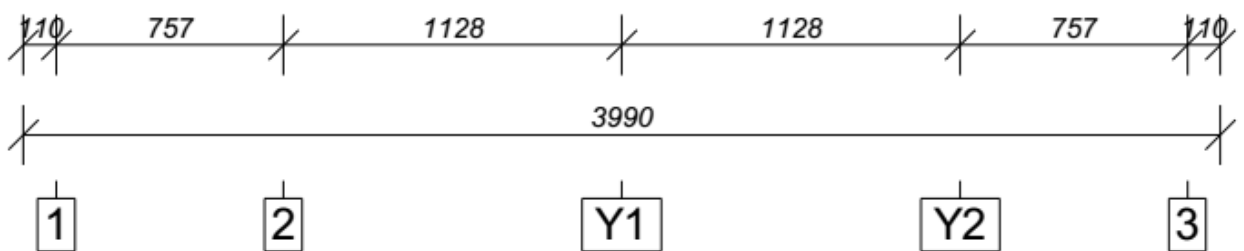
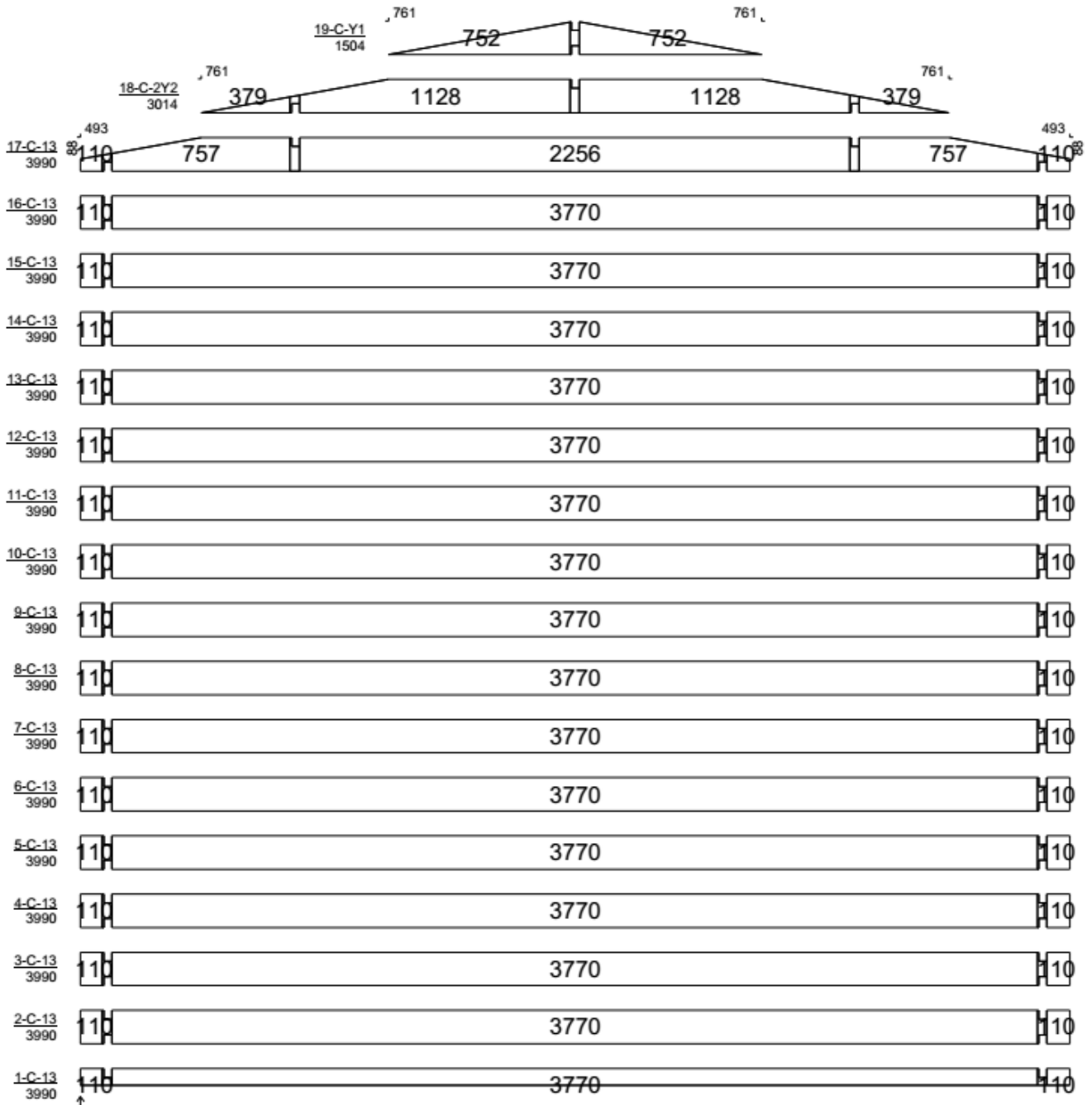

# Wall on axis Y1



We recommend 2 screw to this wall.

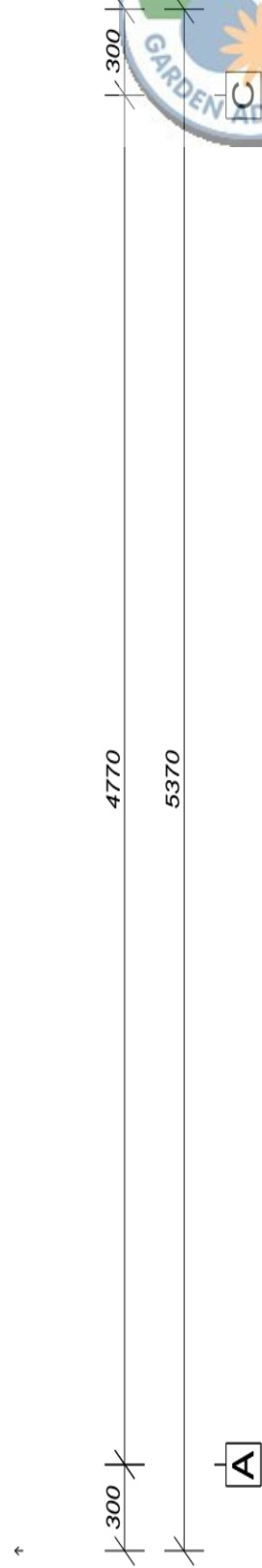

# Wall on axis Y2

17-Y2-AC  
5370



↑

